

DUCATI 749/999 (L)

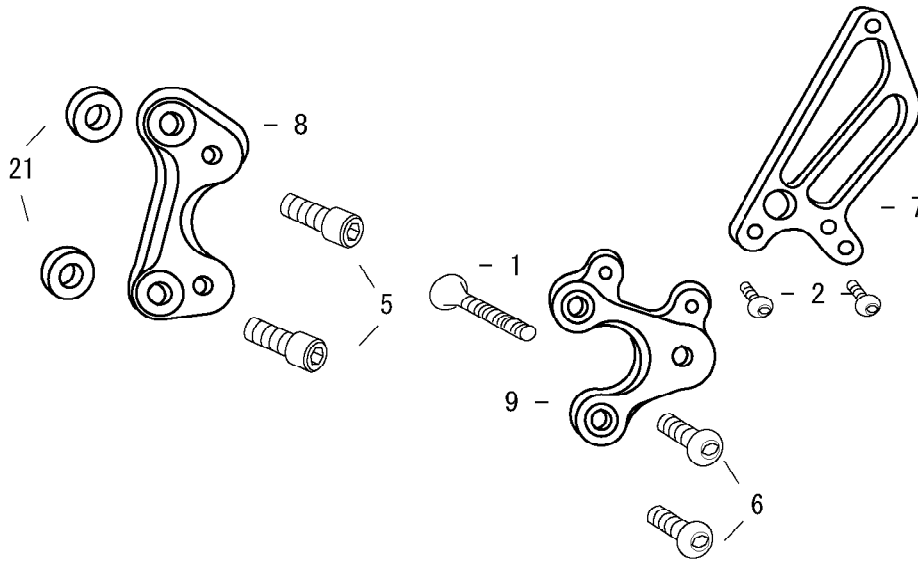

1. FLAT HEAD M8 × 45mm
2. BUTTON HEAD M6 × 10mm × 2
3. BUTTON HEAD M6 × 20mm
4. BUTTON HEAD M6 × 20mm
5. SOCKET HEAD M8 × 25mm × 2
6. BUTTON HEAD M8 × 15mm × 2
7. HEEL GUARD [L] (HG6)
8. BASE PLATE [L]
9. STEP PLATE [L]
10. BEARING COLLAR SUS
11. SHIFT PEDAL 70 (SPD2)
12. SHIFT ROD 180
13. MALE REVERSE ROD END M6
14. REVERSE JAM NUT M6
15. FEMALE ROD END M6
16. STUD M6
17. JAM NUT M6
18. FOOT PEG
19. PEDAL TIP DELRIN
20. ROD END COLLAR 3 × 2
21. BASE PLATE COLLAR 8 (BK) × 2
22. SOCKET HEAD M6 × 25mm
23. PEG WASHER M8
24. FOOT PEG END CAP

★USE STOCK CHANGE ARM, NUT AND BOLT.

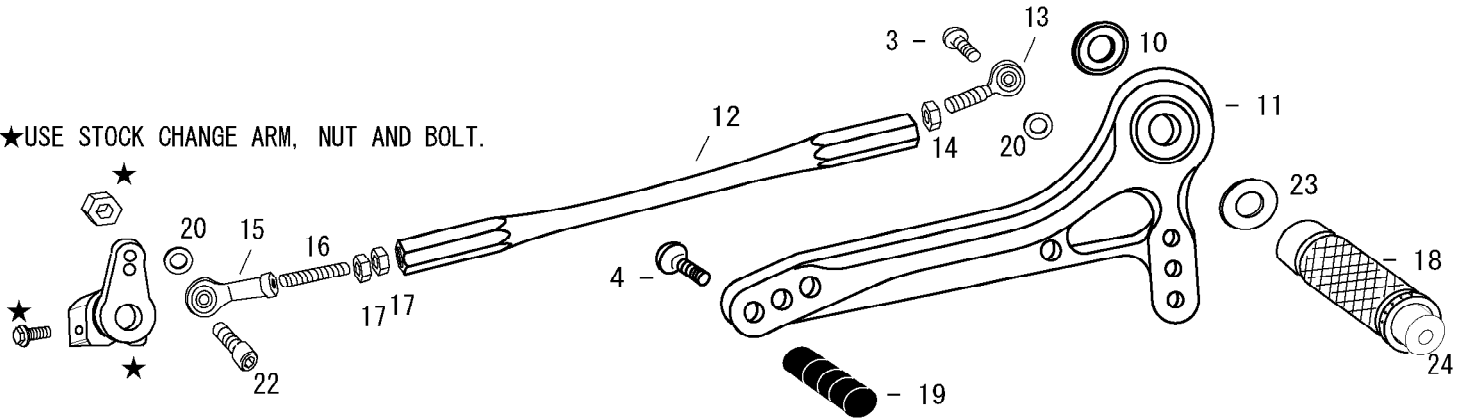

※ADJUST THE STOCK CHANGE ARM WHEN INSTALLING SATO REAR SETS.



DUCATI 749/999 (R)

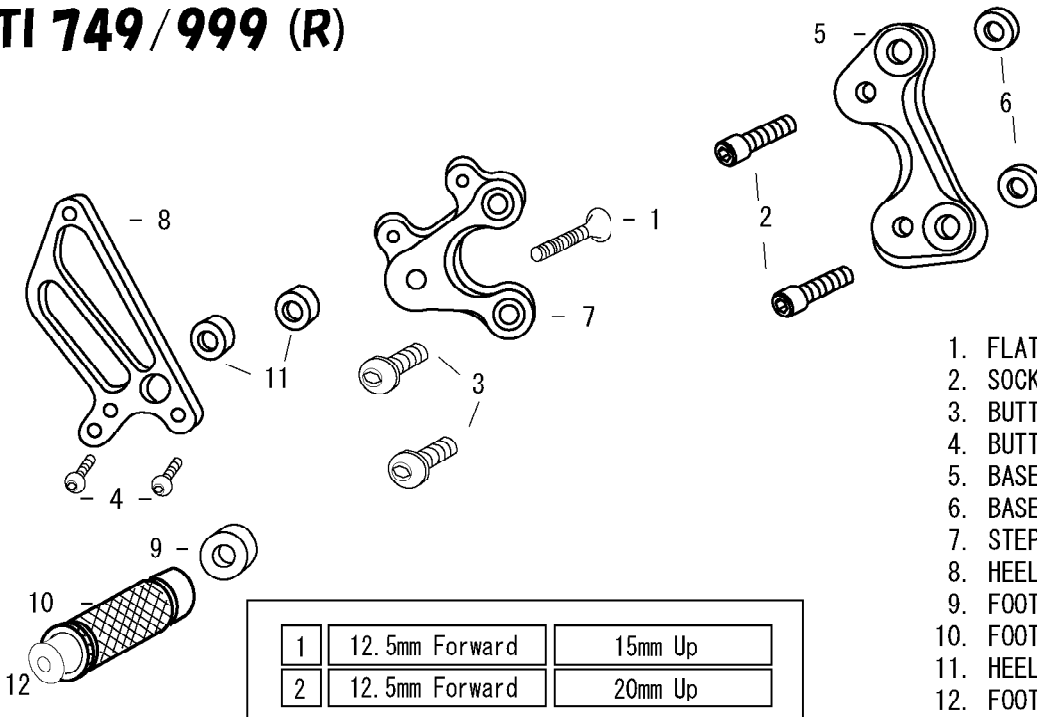

1. FLAT HEAD M8 × 45mm
2. SOCKET HEAD M8 × 25mm × 2
3. BUTTON HEAD M8 × 15mm × 2
4. BUTTON HEAD M6 × 20mm × 2
5. BASE PLATE [R]
6. BASE PLATE COLLAR 8 (BK) × 2
7. STEP PLATE [R]
8. HEEL GUARD [R] (HG6)
9. FOOT PEG COLLAR 15
10. FOOT PEG
11. HEEL GUARD COLLAR 10 (BK) × 2
12. FOOT PEG END CAP

1	12.5mm Forward	15mm Up
2	12.5mm Forward	20mm Up

All measurements are in relation to stock position (0 mm)