

# Buell XB9R/12R Rear Sets

[L]

Flat side of BEARING COLLAR SUS (#17) should face SHIFT BASE (#16), with the rounded side facing out toward pedal bearing.

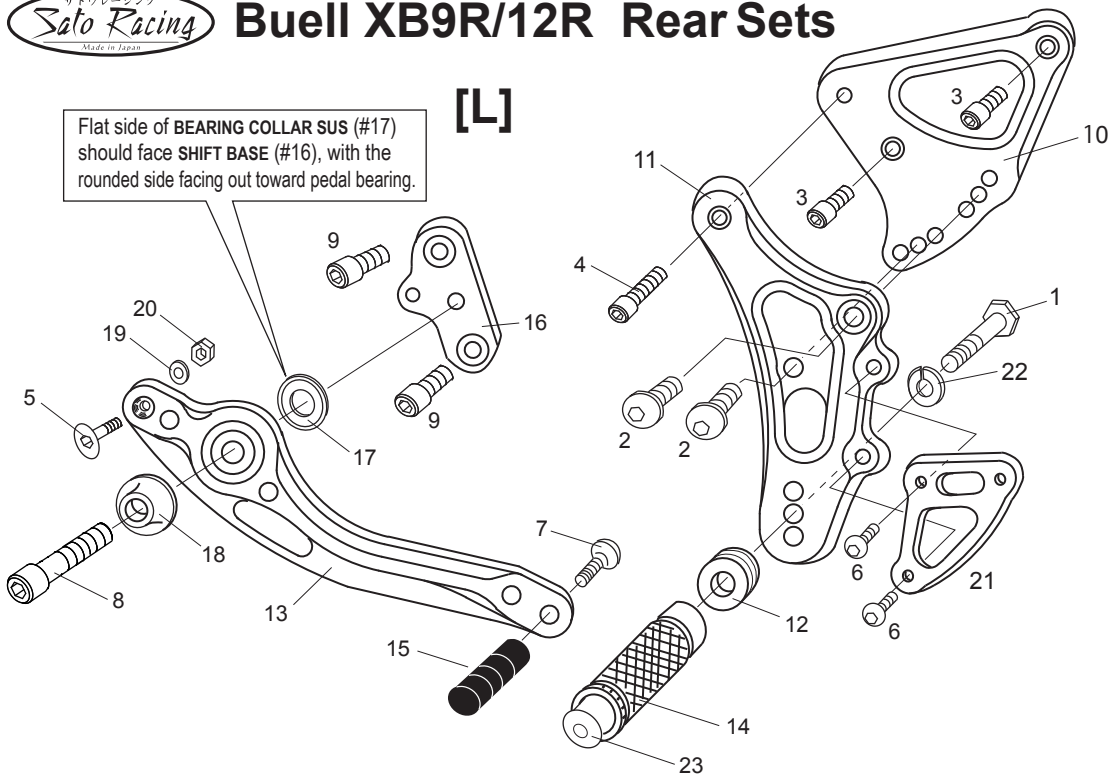

[L]-SIDE

1. HEX BOLT M8×45mm
2. BUTTON HEAD M8×15mm ×2
3. (1/4-20) 5/8 INCH BOLT×2
4. (1/4-20) 1 INCH BOLT
5. SPECIAL BOLT M5×20mm
6. BUTTON HEAD M6×10mm ×2
7. BUTTON HEAD M6×20mm
8. SOCKET HEAD M8×30mm
9. (5/16-18) 5/8 INCH BOLT×2
10. BASE PLATE [L]
11. STEP PLATE [L]
12. FOOT PEG COLLAR 12
13. SHIFT PEDAL (BPD6)
14. FOOT PEG
15. PEDAL TIP DELRIN
16. SHIFT BASE
17. BEARING COLLAR SUS
18. BEARING BOLT COVER(GD)
19. PLAIN WASHER M5
20. PLAIN NUT M5
21. HEEL GUARD [L](HG11)
22. SPLIT WASHER M8
23. FOOT PEG END CAP

※ADJUST THE STOCK CHANGE ARM WHEN INSTALLING SATO REAR SETS.

[R]

No brake light switch included.

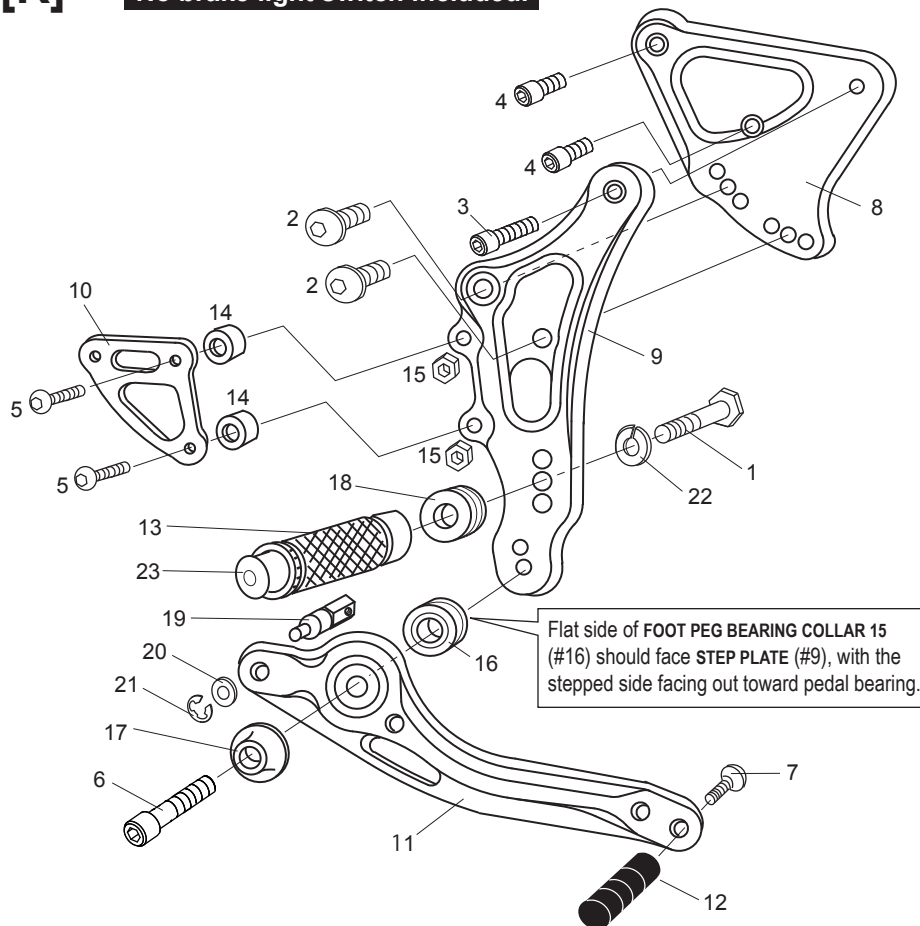

Flat side of FOOT PEG BEARING COLLAR 15 (#16) should face STEP PLATE (#9), with the stepped side facing out toward pedal bearing.

[R]-SIDE

1. HEX BOLT M8×45mm
2. BUTTON HEAD M8×15mm ×2
3. (1/4-20) 1 INCH BOLT
4. (1/4-20) 5/8 INCH BOLT×2
5. BUTTON HEAD M6×40mm ×2
6. SOCKET HEAD M8×45mm
7. BUTTON HEAD M6×20mm
8. BASE PLATE [R]
9. STEP PLATE [R]
10. HEEL GUARD [R](HG11)
11. BRAKE PEDAL 165(BPD3)
12. PEDAL TIP DELRIN
13. FOOT PEG
14. HEEL GUARD COLLAR 10(BK)×2
15. PLAIN NUT M6 ×2
16. FOOT PEG BEARING COLLAR 15
17. BEARING BOLT COVER(GD)
18. FOOT PEG COLLAR 12
19. BRAKE ROD S35
20. PLAIN WASHER M6
21. E CLIP M6
22. SPLIT WASHER M8
23. FOOT PEG END CAP

POSITIONS

	15mm Forward	0mm
1	15mm Forward	0mm
2	15mm Forward	10mm Up
3	15mm Forward	10mm Down
4	0mm	0mm
5	0mm	10mm Up
6	0mm	10mm Down
7	15mm Back	5mm Down
8	15mm Back	5mm Up
9	15mm Back	15mm Up

All measurements are in relation to stock position (0 mm)